

SELECTED FEATURES

NOTES

1. MATERIAL: ALUMINUM
2. FINISH: MILL
3. LOADING: 300 PSF
4. 316 SS NUTS & BOLTS
5. APPROX HATCH WT: 43.41 LBS

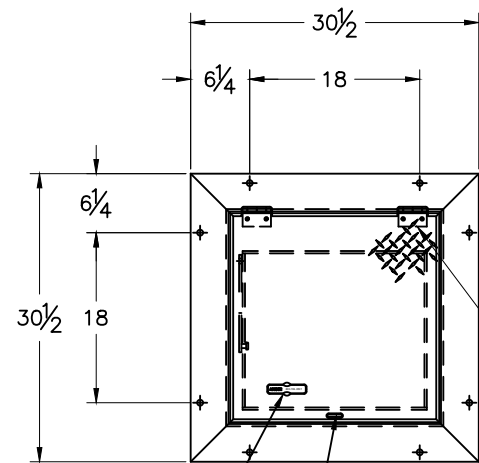

FLUSH CAST ALUM
DROP HANDLE

STAPLE FOR
PADLOCK

1/4" FLOOR PLATE

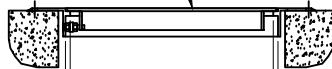

21.500
ACTUAL CLEAR OPENING
22 1/2 FRAME OPENING
24 CONCRETE OPENING

316 S.S. HINGE WITH
TAMPER PROOF
BOLTS

20.000
ACTUAL
CLEAR
OPENING

316 S.S. AUTOMATIC
HOLD OPEN ARM
W/RED VINYL GRIP

22 1/2
FRAME
OPENING

24
CONCRETE
OPENING

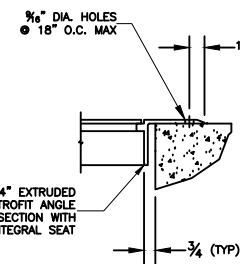

FRAME DETAIL

NOTE:
AS AN AUTOMATED DRAWING, THE DESIGN HAS NOT BEEN REVIEWED BY
USFF ENGINEERING AND IS THEREFORE TO BE USED FOR REFERENCE ONLY.
USFF RESERVES THE RIGHT TO ADJUST DIMENSIONS TO INSURE ADHERENCE
TO CUSTOMER REQUIREMENTS AND PROPER OPERATION OF THE PRODUCT.

THIS DOCUMENT IS THE PROPERTY OF ACUDOR PRODUCTS, INC AND CONTAINS PROPRIETARY
INFORMATION. IT SHALL NOT BE MODIFIED, COPIED, FURNISHED NOR DISTRIBUTED (IN WHOLE OR
IN PART) WITHOUT PROPER AUTHORIZATION OF ACUDOR PRODUCTS, INC.

INTERPRET DIMENSIONS AND TOLERANCES PER ASME Y14.5M
BREAK ALL SHARP CORNERS & EDGES TO 0.01
<u>TOLERANCES UNLESS OTHERWISE SPECIFIED FRACTIONAL</u>
INCHES = ± 1/16
1/16 = ± 1/32
1/32 = ± 1/64

COPYRIGHT © 2016
ALL RIGHTS RESERVED

ACUDOR PRODUCTS

**RETROFIT HATCH FA-300 ALUM
FOR 24 X 24 EXISTING OPENING**

DWN. BY: BOB	SCALE: 1:20	SHEET: 1 OF 1	DATE: 10/23/17
CHK. BY: BOB	DWG # 1000085705	SHEET SIZE: A	REV: 0